

# City of Windcrest

## SPRING CURB SIDE BRUSH & BULK PICK UP

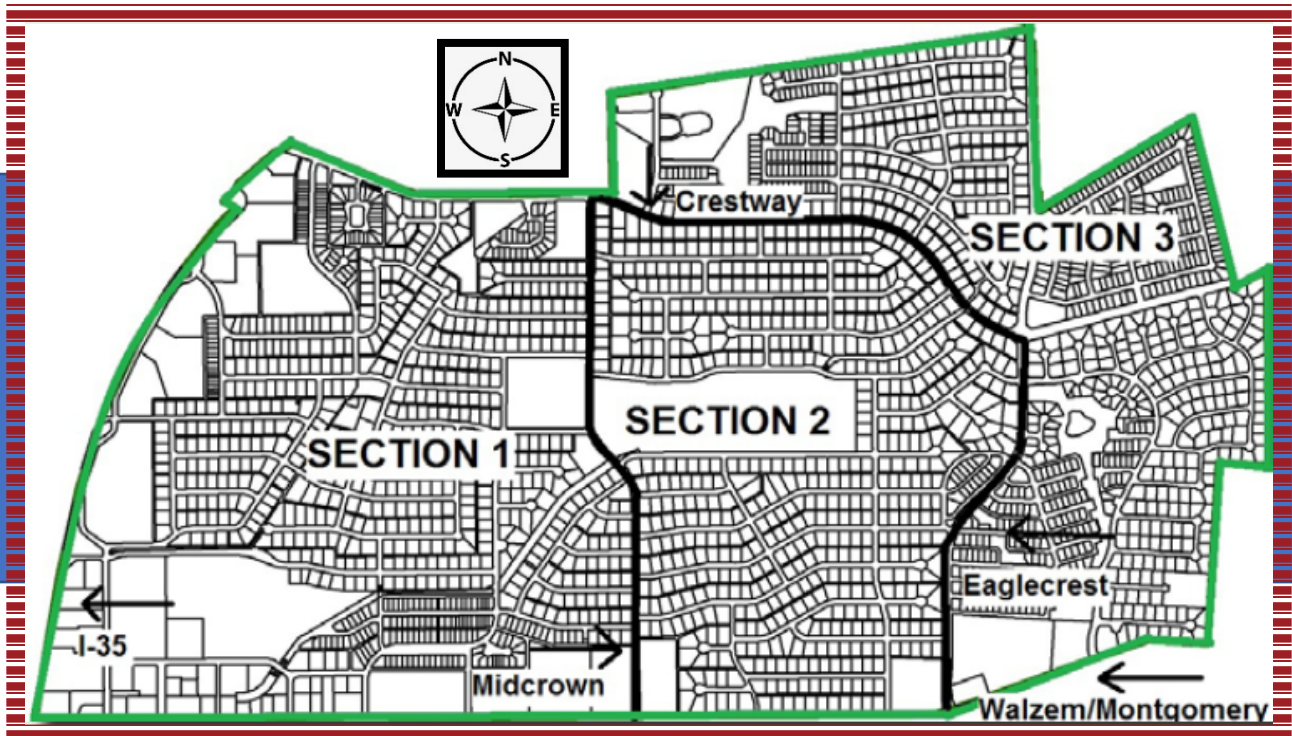

### THE CITY OF WINDCREST CURBSIDE BRUSH AND BULK PICK UP WILL RUN APRIL 12, 2021 TO APRIL 30, 2021.

This service is for WINDCREST RESIDENTS ONLY. Brush and bulk collection will be picked up in sections throughout the city. For your reference, please refer to the guidelines below to identify the section your collection will occur.

Our Spring bulk and brush collection will begin in SECTION 1.

**SECTION 1:** All homes located **west of Midcrown** are located in Section 1. Curbside service will begin on **Monday, April 12, collecting through Friday, April 16**. ALL brush and bulk items to be collected **MUST** be placed out on the curb **NO EARLIER than Friday, April 9, and NO LATER than Sunday, April 11**. Collection will only be picked up once in each section. Republic Service **WILL NOT** return for additional pick-ups or missed pick-ups due to collection not being placed out by Sunday, April 11.

**SECTION 2:** All homes located **east of Midcrown, south of Crestway, and west of Eaglecrest** are located in Section 2. Curbside service will begin on **Monday, April 19,**

**collecting through Friday, April 23.** ALL brush and bulk items to be collected **MUST** be placed out on the curb **NO EARLIER than Friday, April 16,** and **NO LATER than Sunday, April 21.** Collection will only be picked up once in each section. Republic Service **WILL NOT** return for additional collection or missed collections due to items not being placed out by Sunday, April 21.

**SECTION 3:** All homes located **north of Crestway and east of Eaglecrest are located in Section 3.** Curb side service will begin on **Monday, April 26, collecting through Friday, April 30.** ALL brush and bulk items to be collected **MUST** be placed out on the curb **NO EARLIER than Friday, April 23.** and **NO LATER than Sunday, April 25.** Collection will only be picked up once in each section. Republic Service **WILL NOT** return for additional collection or missed collections due to items not being placed out by Sunday, April 25.

Please refer to the map above to confirm the section your collection will be picked up. Each section will be serviced **ONCE.** Make sure your collection is out on the curb by the prescribed date, otherwise you will miss out on the Fall collection service. Do not place material at the curb after crews have passed by your house.

Need to know what are acceptable collection for this service? Refer to the guidelines listed below. If you have questions on items not identified below, please call City Hall at 210-655-0022.

### Brush/Bulky Guidelines:

- Limit your brush pile to five (5) cubic yards
- To determine the cubic yards, take the Length x Width x Height of the pile and divide by 27. (this will equal the cubic yards for example 5ft long by 5ft Wide by 5ft High = 125 divided by 27 equals 4.63 cubic yards.
- Brush must be placed within eight (8) feet of the curb.
- Do not place brush piles in front of parked cars, near fences, trees, mailboxes, beneath overhead wires, low-hanging tree limbs, or on top of gas/water meters.
- Accepted Materials: Shrubs, Tree Branches, Woody Vines, Other herbaceous and woody plants, BBQ grills (without compressed gas tanks), Carpeting, Fencing, Furniture, Mattresses, Toilets, Water heaters, Appliances

\*\*\*Refrigerators, freezers, and a/c window units will be collected only if refrigerant has been removed and the appliance is tagged and certified, indicating removal of refrigerant\*\*\*.

### Materials Not Accepted

Household Trash, Construction Debris, Glass (such as doors or Windows), Hazardous Materials (paints, household cleaners), Compressed Gas Tanks, Tires, Televisions, Computers, Waste Oil, Medical Waste, Appliances with refrigerant that has not been removed and certified.

NOTE: Hazardous Waste drop off day will be schedule in the Fall. NO hazardous waste collection will be scheduled for the Spring.